

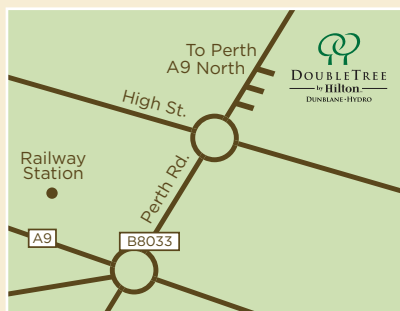

## LOCATION

Dating back to 1878 the Doubletree by Hilton Dunblane Hydro is located in over 10 acres of gloriously landscaped grounds, overlooking Dunblane and its 12th century Cathedral with the Perthshire countryside in the distance. The hotel is situated just off the M9/M80 near Stirling, and Dunblane train station is less than a mile away and is on main line routes. We are also less than an hour's drive from both Edinburgh and Glasgow International Airports.



## FACILITIES & SERVICES

- 200 guest rooms, including 4 Suites, 8 Junior Suites and Deluxe rooms with stunning views. We also have 5 accessible rooms for guests with special needs
- 8 conference & meeting rooms, including our Strathallan Suite, which can accommodate up to 600 delegates
- Wi-Fi access available in public areas, meeting rooms and bedrooms
- Business Centre
- Complimentary on-site car parking

### Doubletree by Hilton Dunblane Hydro

Perth Road, Dunblane FK15 OHG

Tel: 01786 822551

[www.dunblanehydro.doubletree.co.uk](http://www.dunblanehydro.doubletree.co.uk)

## ALL ROOMS FEATURE

- Sweet Dreams™ by Doubletree sleep experience with Super Topper fitted mattress pad, luxurious linens, down comforter and jumbo pillows
- Tea & coffee making facilities
- LCD television & movies on demand
- Wi-Fi internet access (charge applies)
- Laptop safe
- Iron & ironing board
- Hairdryer
- MP3 alarm clock
- Workdesk with powerpoints
- Full length mirror
- Complimentary Neutrogena toiletries

## DINING & ENTERTAINMENT

- The Kailyard Restaurant by Nick Nairn (opens late 2009) offering contemporary dining in a relaxed atmosphere
- Cocktail Bar & Stuart Lounge provides a modern and friendly area for drinks or light snacks
- Wallace Lounge offers stunning décor and views for informal drinks and private dining options
- 24-hour Room Service menu provides tasty and healthy options alike

## RECREATION

- Our Livingwell Health & Leisure Club offers:
- Fully equipped Precor Gym
  - Indoor heated swimming pool
  - Bubble Pool
  - Sauna
  - Steam Room
  - 3 beauty treatment rooms
  - Professional and trained staff
  - Manicures, massages and facials
  - Spa packages available (both half/full days, Girls weekends and Weddings)

## SURROUNDING ATTRACTIONS

- Stirling Castle (5 miles)
- Wallace Monument (5 miles)
- Blair Drummond Safari Park (12 miles)
- Loch Lomond & Trossachs National Park (14 miles)
- Loch Katrine (18 miles)
- University of Stirling (5 miles)
- Dunblane Cathedral (0.5 miles)
- Tullibardine Distillery (18 miles)
- Falkirk Wheel (20 miles)
- Dunblane Golf (0.5 miles)

## PERSONALIZED GROUP WEB PAGE

Provides your guests with an Online Group web page that is customized for their event. This allows group attendees to book their reservations online 24/7. Ask your sales person for details.

## HILTON HHONORS®

- Points & Miles® and No Blackout Dates. Hilton HHonors® is the only hotel guest reward program to offer it all, at more than 3,000 hotels worldwide
- With the Hilton HHonors Event Bonus Programme, event planners can earn Points & Miles® for qualifying events at Hilton Family hotels outside the United States and Canada. Ask your sales person for details

Hilton HHonors® Event Planner bonus is valid for new event bookings only and is awarded at the discretion of the hotel and may not be awarded on all group business events. Other restrictions may apply. For full Event Bonus details including Terms and Conditions, please visit [www.HiltonHHonors.com/eventbonus](http://www.HiltonHHonors.com/eventbonus). Hilton HHonors® membership, earning of Points & Miles® and redemption of points are subject to HHonors Terms and Conditions. ©2009 Hilton Hotels Corporation

## MEETING & BANQUET FACILITIES



### Meeting Accommodations

- Conference capacity for up to 600 delegates
- Banquet facilities catering for up to 400 delegates
- 8 meeting rooms to suit all requirements
- Dedicated business centre
- Wi-Fi in all meeting rooms
- Free car parking

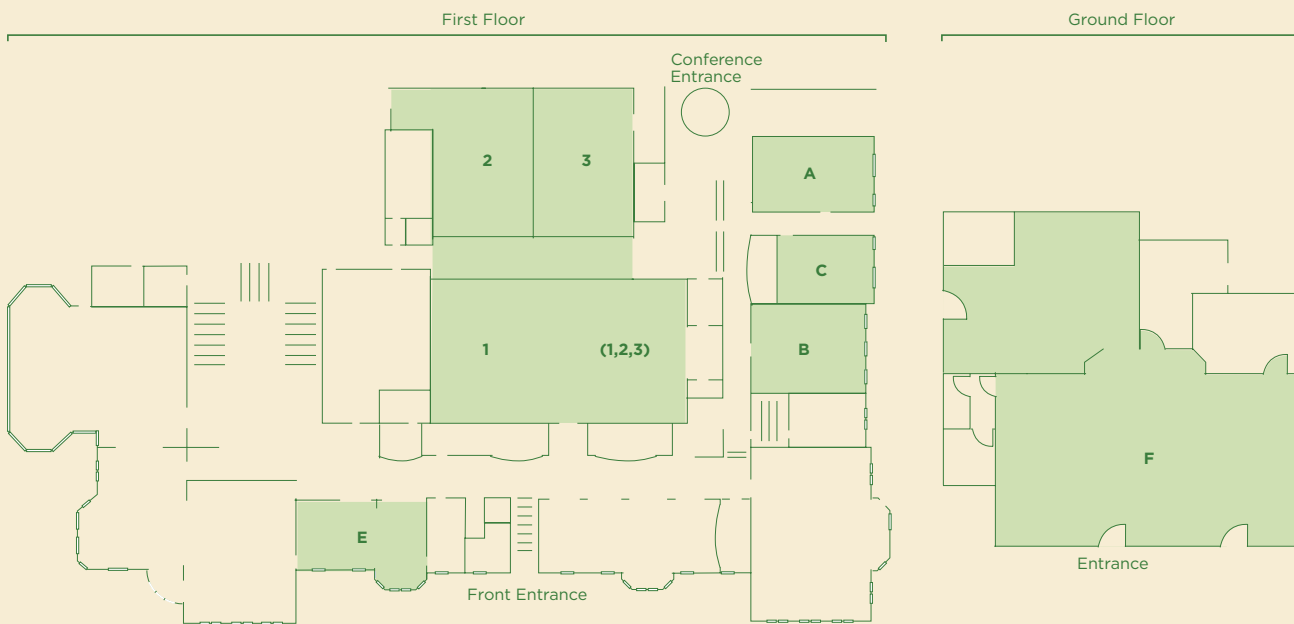

Room Name	Dimensions Ceiling Height (min/max)	Theatre	Classroom	Cabaret	Boardroom	U-Shape	Banquet	Dinner Dance
Strathallan (1,2,3)	28.4 x 18 (4)	600	240	300	-	-	400*	*300
Strathmore (1)	18 x 12.5 (4)	300	145	150	50	50	160	140
Strathyre (2)	9 x 12 (4)	70	36	60	24	26	60	-
Strathspey (3)	9 x 12 (4)	70	36	60	24	26	60	-
MacLeod (F)	15.2 x 9.2 (1.5)	150	80	80	40	40	110	70
Wallace Lounge (E)	11.6 x 5.8 (3.8)	25	12	INQ	15	15	20	-
Glenallan (A)	10.15 x 6.28 (3.8)	60	26	20	20	20	40	-
Glendevon (B)	9.5 x 7.3 (3)	60	30	30	24	24	40	-
Glenside (C)	8 x 5.8 (2.5)	40	30	20	18	16	20	-

\*volume total without stage